



# KINGGATES

KING GATES SRL - Via A. MALIGNANI, 42 - 33077 SACILE (PN) ITALY

TEL. +39 (0)434 737082 - FAX +39 (0)434 786031- P.IVA 016098760939

## Wireless keypad - KPD-ABC-SQ-0-K (DIGYPAD)

### A. General description

- 1) Allows **keyless entry** / exit, by punching a secured combination code of numbers.
- 2) Up to 3 different codes A, B, C, codes can be from 1 to 8 numbers.
- 3) Suitable for opening KINGgates equipment, and other brands with a KINGgates receiver.
- 4) To be installed up to 30 meters range from the equipment (gate, Garage door, etc.).
- 5) No wiring required. The unit is wireless, and battery powered.
- 6) For flat vertical surface installation as wall, posts etc.
- 7) Weatherproof for outdoor, and indoor installations - IP54
- 8) Battery to last about 24 months with about 10 operations per day.
- 9) Battery is easy to replace by the user (required some technical skills)
- 10) Back light - the pads light up with the first press of a button
- 11) This unit needs to be paired to the gate

### B. How to use the unit

- 1) Key-in your security code followed by the Letters A, or B, or C.
- 2) 6 seconds allowed between each press of a button.
- 3) Beep confirmation will be heard - see the table below.

BEEP SIGNALS	MEANING
1 short beep	Confirms a key press.
1 long beep	More than 6 seconds try again from the beginning.
3 long beeps	<ul style="list-style-type: none"><li>• For code programing - Code have been successfully changed</li><li>• With regular use - Battery low -replace the battery, you will hear the beeps with the new battery stalled correctly</li></ul>
5 short beeps	<ul style="list-style-type: none"><li>• something went wrong, re try again</li></ul>
	Series of beeps over 2 sec. indicates that the batteries are exhausted and must be replaced

### C. **Maintenance**

This unit does not require any special maintenance. Check it occasionally for spider webs, dust. wipe and clean wet cloth. Replace the battery if not working.

### D. **Disposing of Battery**

Discharged battery contains pollutant substances and therefore should be recycle. Dispose battery at waste disposal, Battery world shop, or similar.

### E. **Technical Specifications**

All technical specifications stated herein refer to an ambient temperature of 20° C ( $\pm 5^{\circ}$  C)

### F. **SCRAPPING THE PRODUCT**

This product is an integral part of the automation and must therefore be scrapped together with it, in the same way as indicated in the automation's instruction manual.

### G. **Replacing the battery** (see figure on net page)

- 1) Replace the battery every about 12 month, or when it dead. Please recycle the battery
- 2) Remove the two screws at the bottom of the unit – Fig. A
- 3) Extract out the buttons plastic part form the metal case – Fig. B
- 4) Unscrew the battery cover with a coin and replace the battery
- 5) Pay attention to the battery cover seal
- 6) The positive poles (+) is facing you -Fig. 6
- 7) Put new battery and close back the battery cover, screw with the coin- Fig.6
- 8) Fit the plastic button unit back to the metal case – Fig. 7
- 9) Screw the two bottom screws -Fig.8

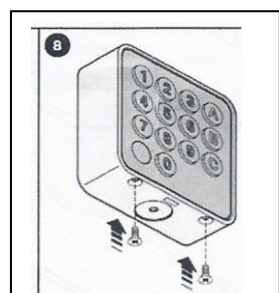
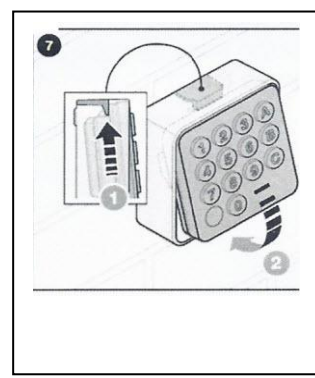
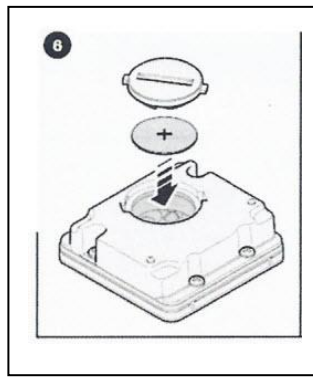
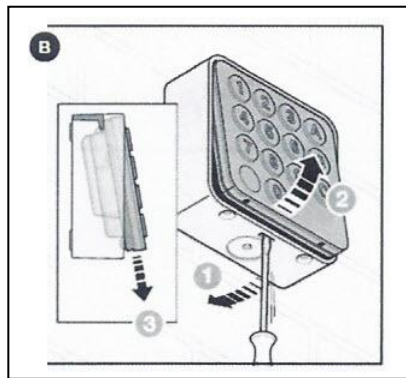
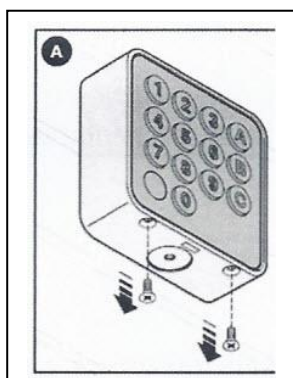

## **INSTALLATION AND PROGRAMING**

### **H. Pairing the keypad to the gate system /control unit / receiver**

**Pairing is done at the gate control unit. you may need a technician for it.**

Paring should be done before installing the unit.

Be ready to operate the unit with a code(s).

The Keypad operates similar to a remote-control unit.

- 1) On the manual of your gate equipment; Follow the remote-control-Unit pairing (programing) instructions.
- 2) Where instructions asks to **press a remote-control unit button**, then operate the keypad by entering a code and a letter, instead of a remote-control unit.

### **I. Factory Default codes**

This unit has up to 3 different opening codes. For the first time, use the factory default codes of the unit. The 3 codes, one for each of the letters. are:

1. 11 followed by the letter A
2. 22 followed by B
3. 33 followed by C

Listen to the correct beep sound when keing the cotrrect code, enter false code and listen to the bip sound

### **J. Programing new security codes**

#### **❖ WARNING!**

Losing a code, or mistake with the codes, will totally damage the unit.

Please read and follow the instructions. You may ask gate technician to do it for you.

Check the default codes before doing the programing, read this instruction manual fully and make sure that you understand it.

The manufacture and Allegro warranties do not apply if codes cannot be presented.

### **i. New coding procedure**

**Note: It is best to try to change Code C first**

- 1) Choose one of the 3 letters for your new security code A or B or C
- 2) Codes are usually 4 digits. optional 1 to 8 digits.
- 3) You have 6 seconds between each press, if 6 seconds pass, you will start this procedure form the beginning
- 4) Press **and hold** the “0” digit.
- 5) **While holding the “0” digit** - press the letter you choose A or B or C and release it
- 6) Release the “0” button
- 7) Enter the old code numbers linked to the letter you choose (A, B, C)
- 8) Press the letter again
- 9) Key-in your new code
- 10) Press the letter you choose
- 11) Key-in your new code again
- 12) Press the letter chosen again

### **K. Example linking the code 2018 to the letter “C”**

- 1) Press and hold the zero (0) button
- 2) While holding the (0) in one hand; Press and release the (C) with the other hand
- 3) Release the “0” button
- 4) Enter the (old) code 3,3,
- 5) Press the letter (C)
- 6) Enter the code again 2,0,1,8
- 7) Press (C) again
- 8) Re-Enter the code again 2,0,1,8
- 9) Press (C) again
- 10) End of procedure

## L. Installation of the unit

- 1) Before installation check reception form the desired installation location
- 2) Choose a flat surface for installation, chose the right high to be comfort for adult and or children users
- 3) Extract out the button plastic part form the metal case – Fig. 2
- 4) Punch holes in the metal case for the screws to fit it to the wall/ post
- 5) Fit the metal case of the unit to the wall / post with screws – Fig. 5
- 6) Put the rectangle black rubber par to its place – Fig. 4
- 7) Install the unit in the correct directions so the numbers and letters are facing up correctly- Fig. 5
- 8) Fit the buttons part back to the case of the unit – Fig. 7
- 9) Screw in the two screws at the bottom – Fig. 8

